

Data Sheet



Article number: 584V330C10EG

Description: Solenoid Valve, type 4V330C10EG
port 3/8" 5/3 - closed center, AC24V

Measures

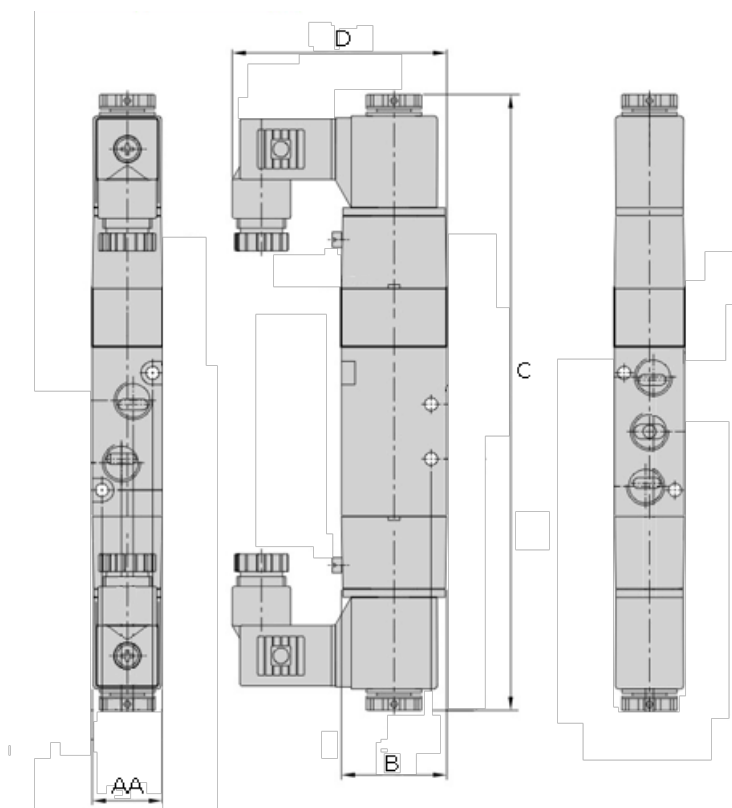

| | |
|--------------------------|----------|
| AA | = 27 |
| B | = 40 |
| C | = 135.0 |
| d | = 69.2 |
| Port exit | = G 3/8" |
| Port supply and blowdown | = G 1/4" |
| Voltage | = 24 VAC |